

G ELECTRICAL WIRING ROUTING

□ : Location of Connector Joining Wire Harness and Wire Harness

▽ : Location of Ground Points

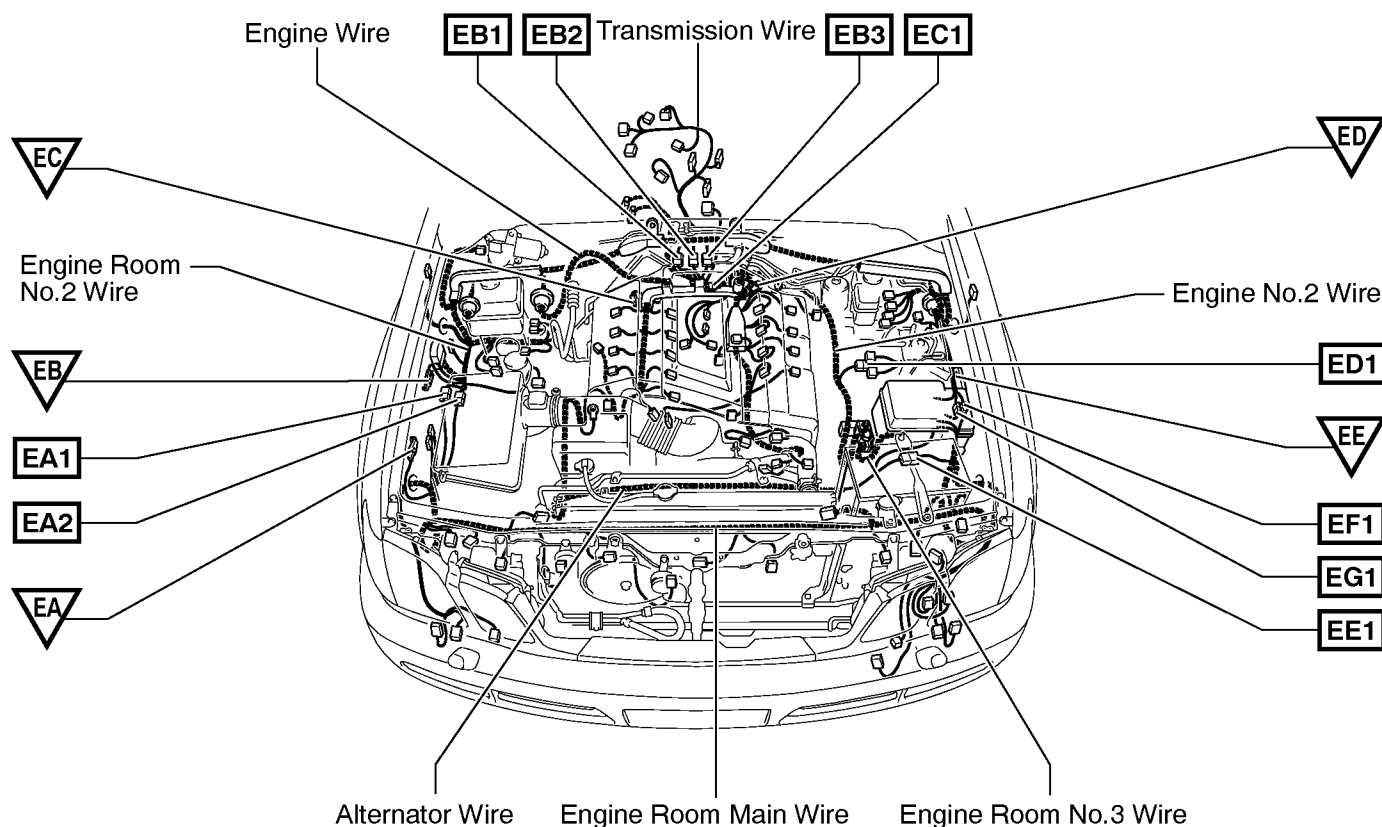

○ : Location of Splice Points

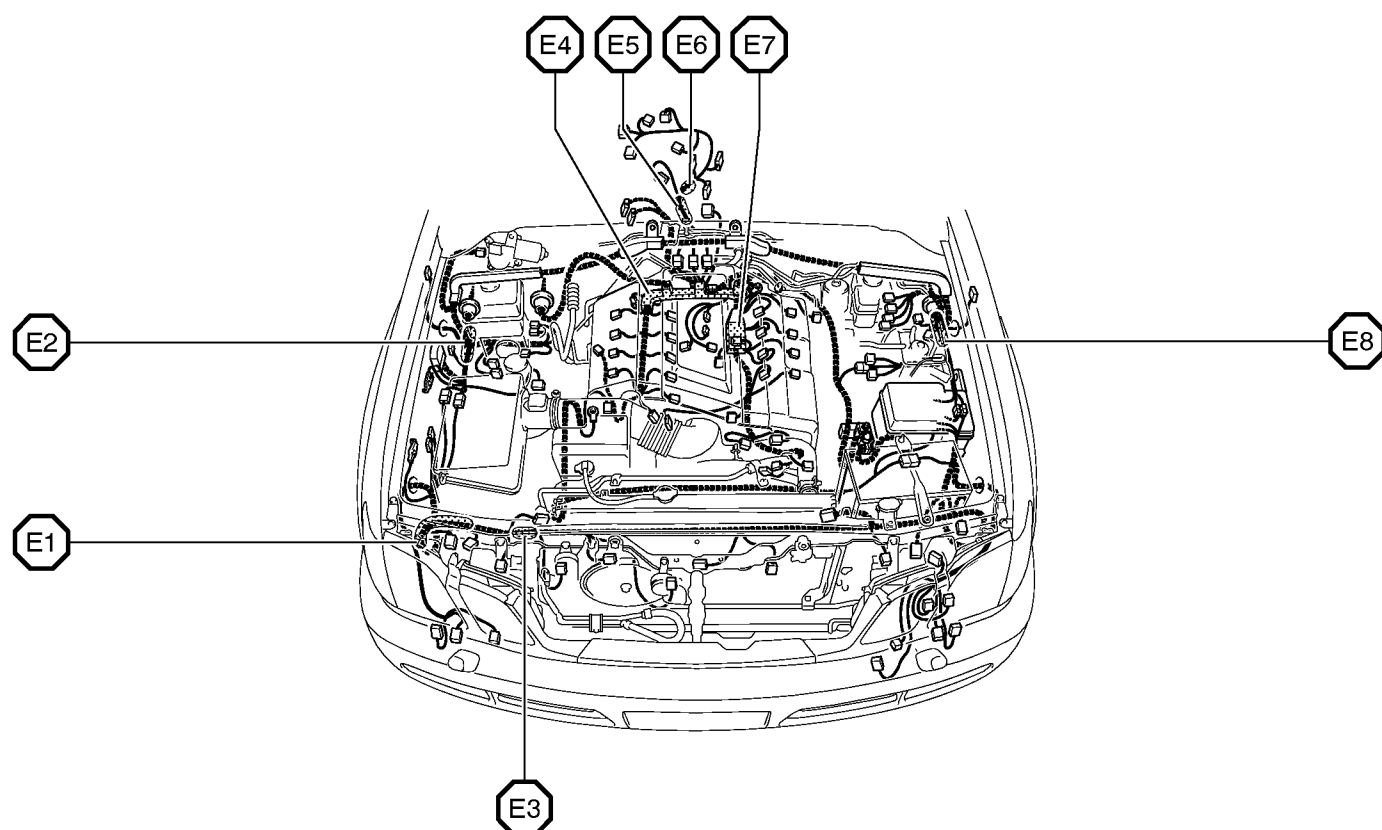

Connector Joining Wire Harness and Wire Harness

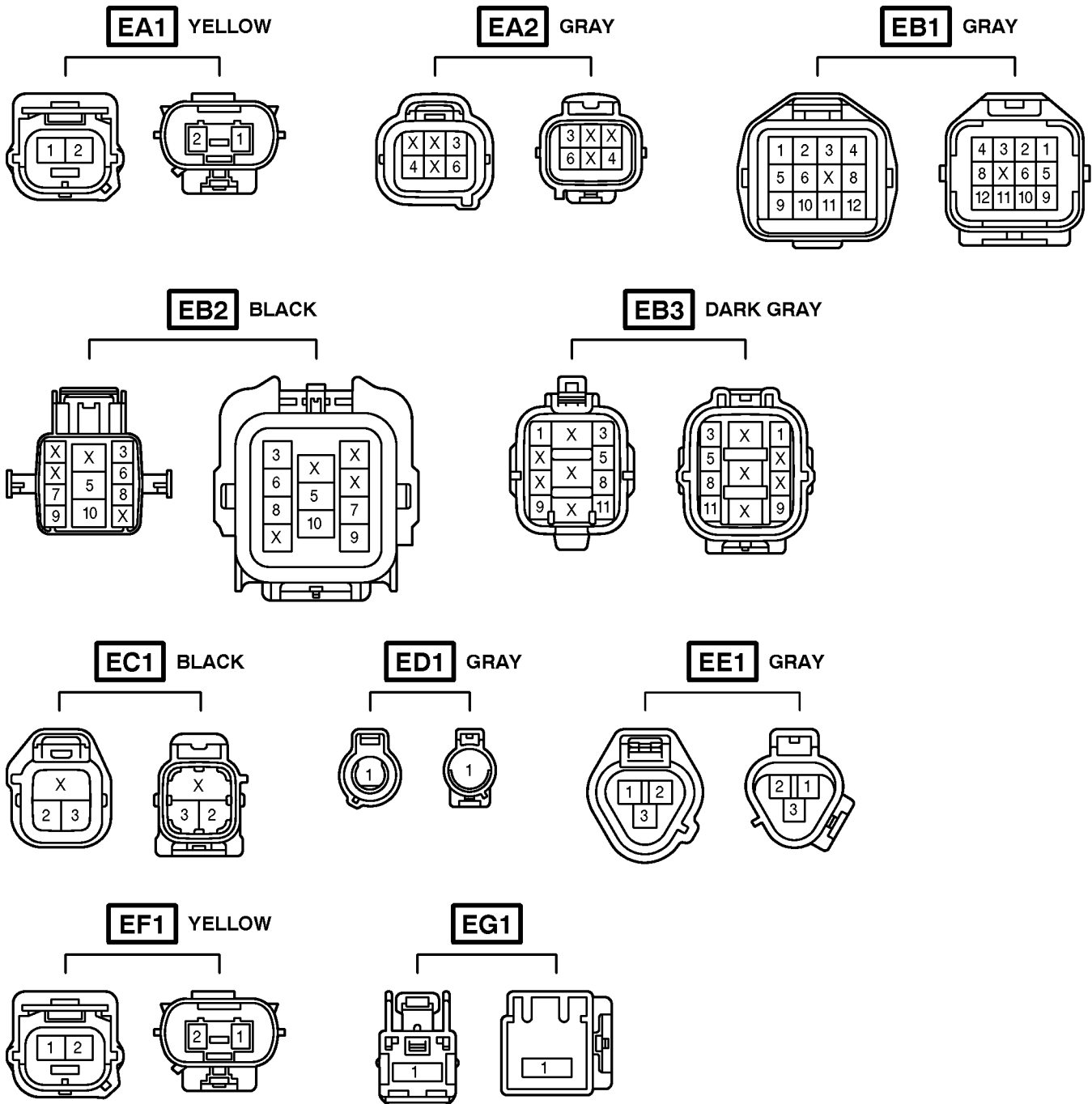

| Code | Joining Wire Harness and Wire Harness (Connector Location) |
|------|---|
| EA1 | Engine Room Main Wire and Engine Room No.2 Wire (Engine Compartment Right) |
| EA2 | |
| EB1 | |
| EB2 | Engine Wire and Transmission Wire (On the Transmission) |
| EB3 | |
| EC1 | Engine No.2 Wire and Engine Wire (On the Transmission) |
| ED1 | Engine No.2 Wire and Engine Room No.2 Wire (Near the Engine Room J/B) |
| EE1 | Engine Room Main Wire and Alternator Wire (Near the Battery) |
| EF1 | Engine Room No.2 Wire and Engine Room Main Wire (Under the Engine Room J/B) |
| EG1 | Engine Room No.2 Wire and Engine Room No.3 Wire (Under the Engine Room J/B) |

G ELECTRICAL WIRING ROUTING

□ : Location of Connector Joining Wire Harness and Wire Harness

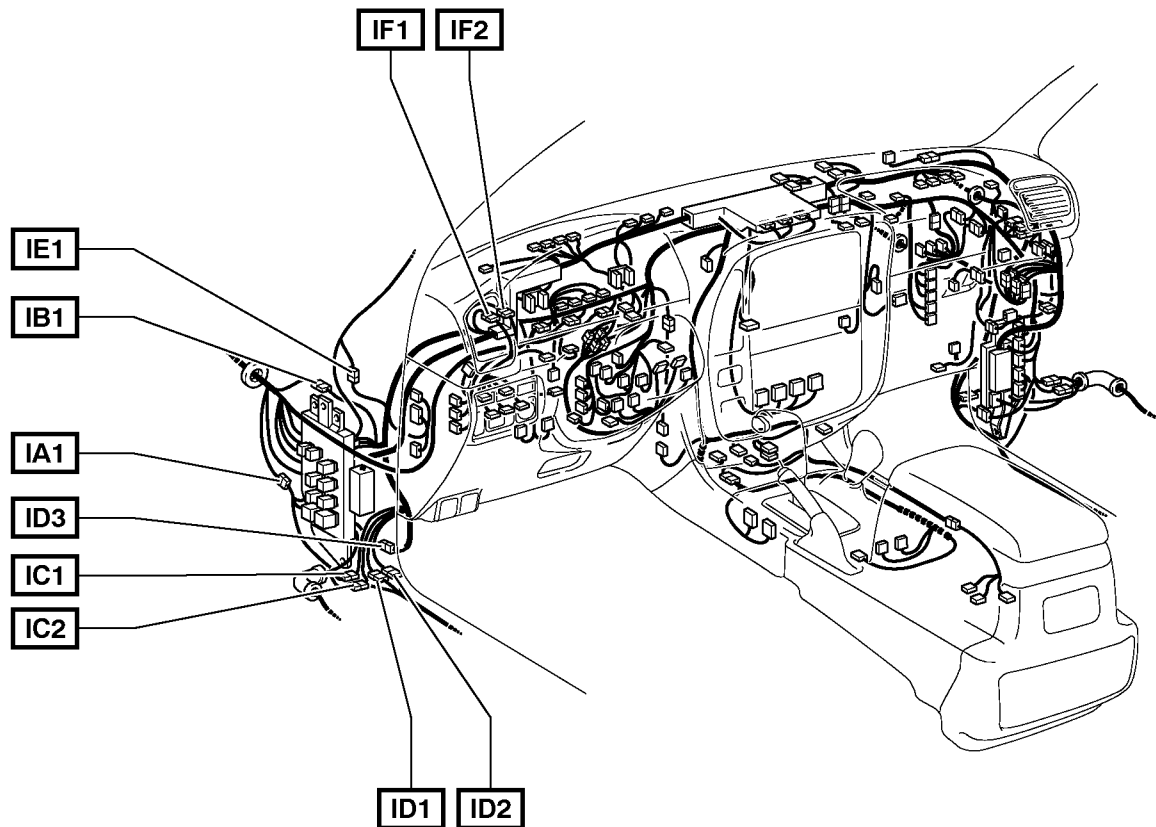

▽ : Location of Ground Points

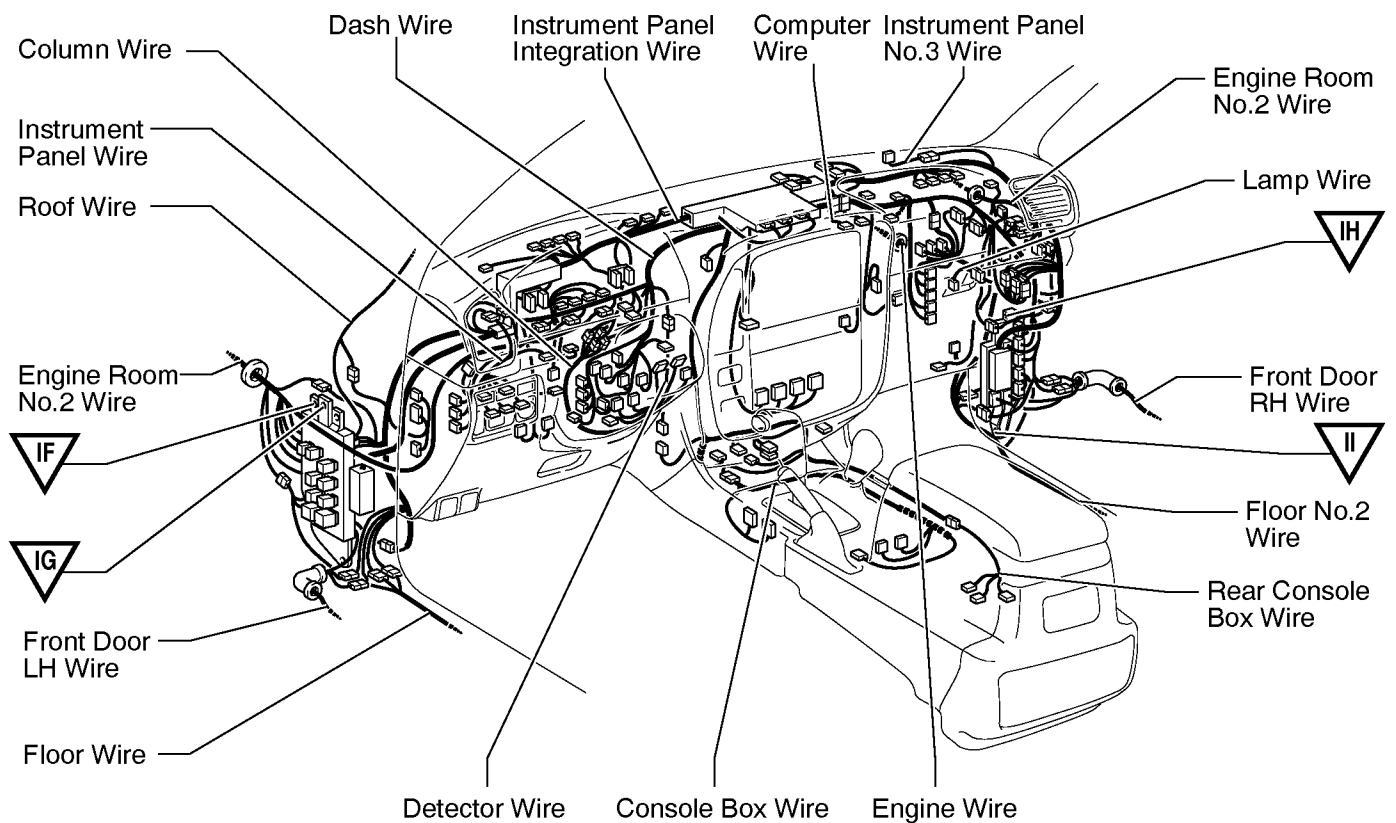

Connector Joining Wire Harness and Wire Harness

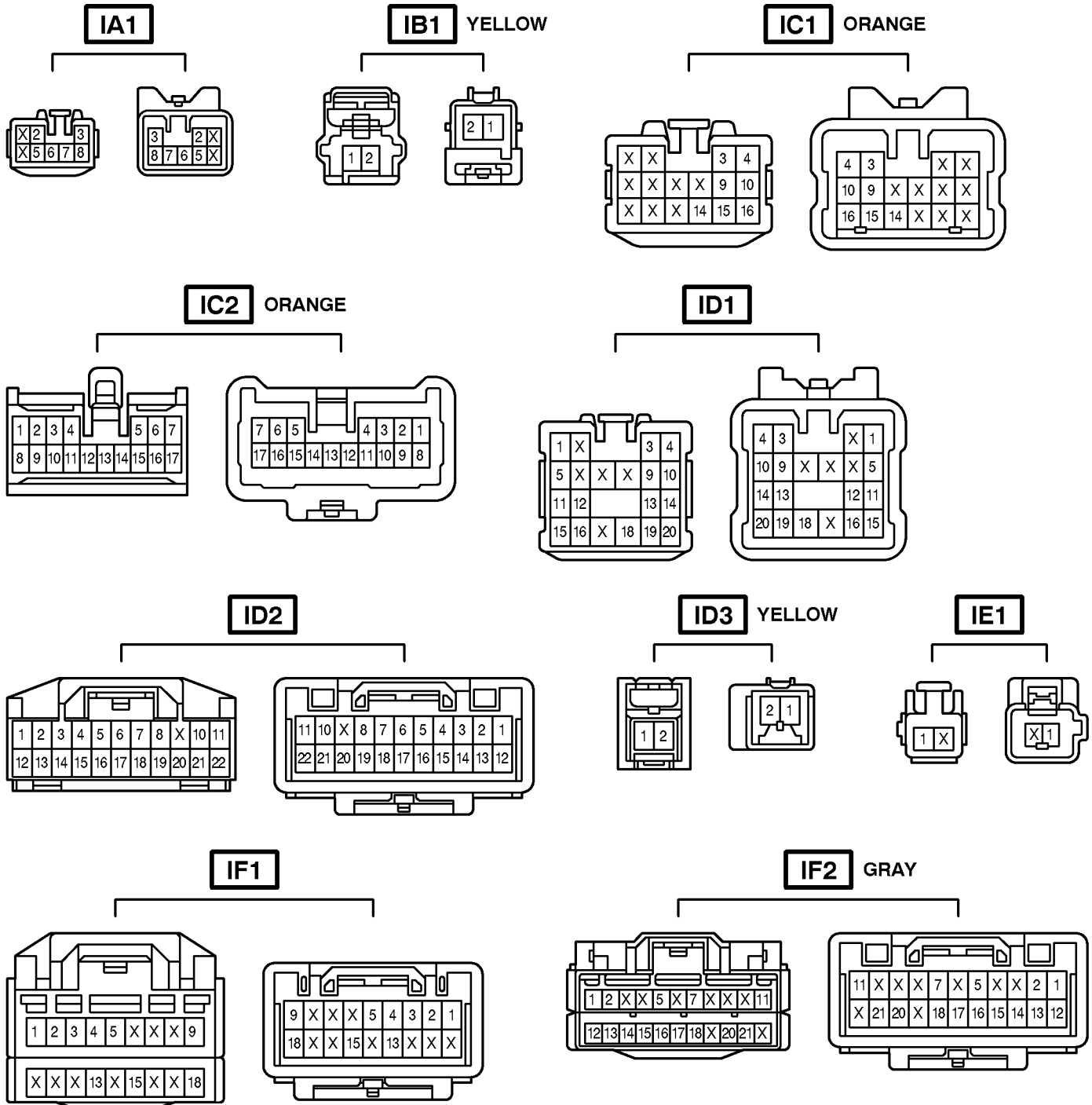

| Code | Joining Wire Harness and Wire Harness (Connector Location) |
|------|---|
| IA1 | Floor Wire and Engine Room No.2 Wire (Left Kick Panel) |
| IB1 | Engine Room No.2 Wire and Dash Wire (Left Kick Panel) |
| IC1 | Front Door LH Wire and Dash Wire (Left Kick Panel) |
| IC2 | |
| ID1 | Dash Wire and Floor Wire (Left Kick Panel) |
| ID2 | |
| ID3 | |
| IE1 | Dash Wire and Roof Wire (Left Kick Panel) |
| IF1 | Instrument Panel Integration Wire and Instrument Panel Wire (Left Side of Instrument Panel) |
| IF2 | |

G ELECTRICAL WIRING ROUTING

□ : Location of Connector Joining Wire Harness and Wire Harness

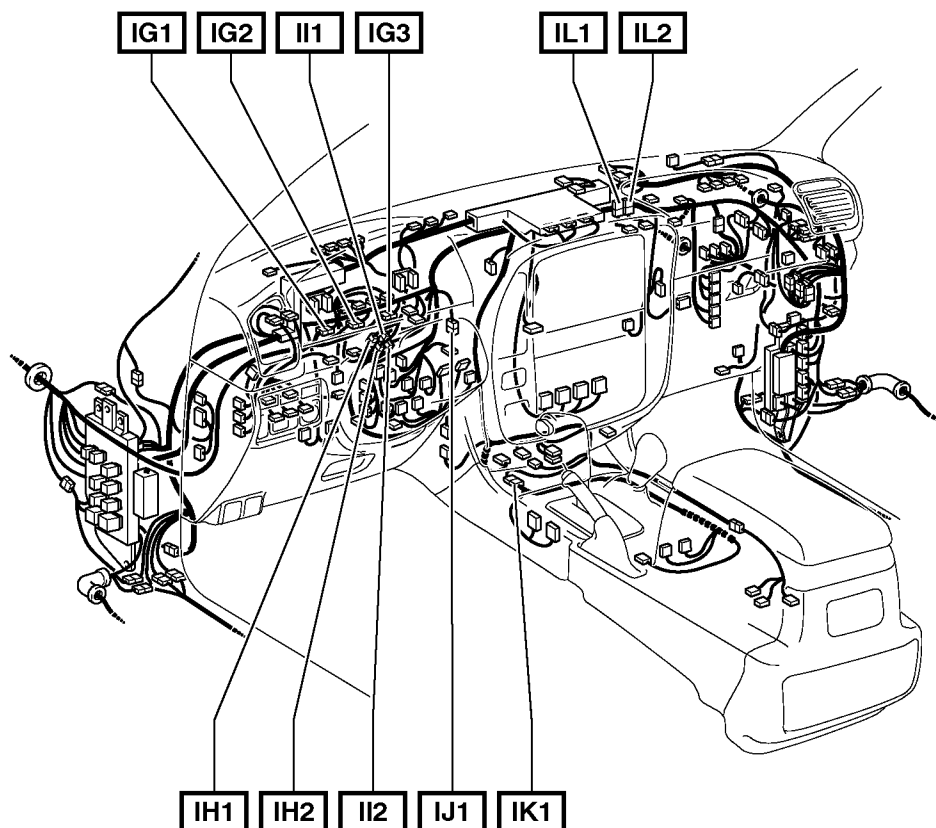

○ : Location of Splice Points

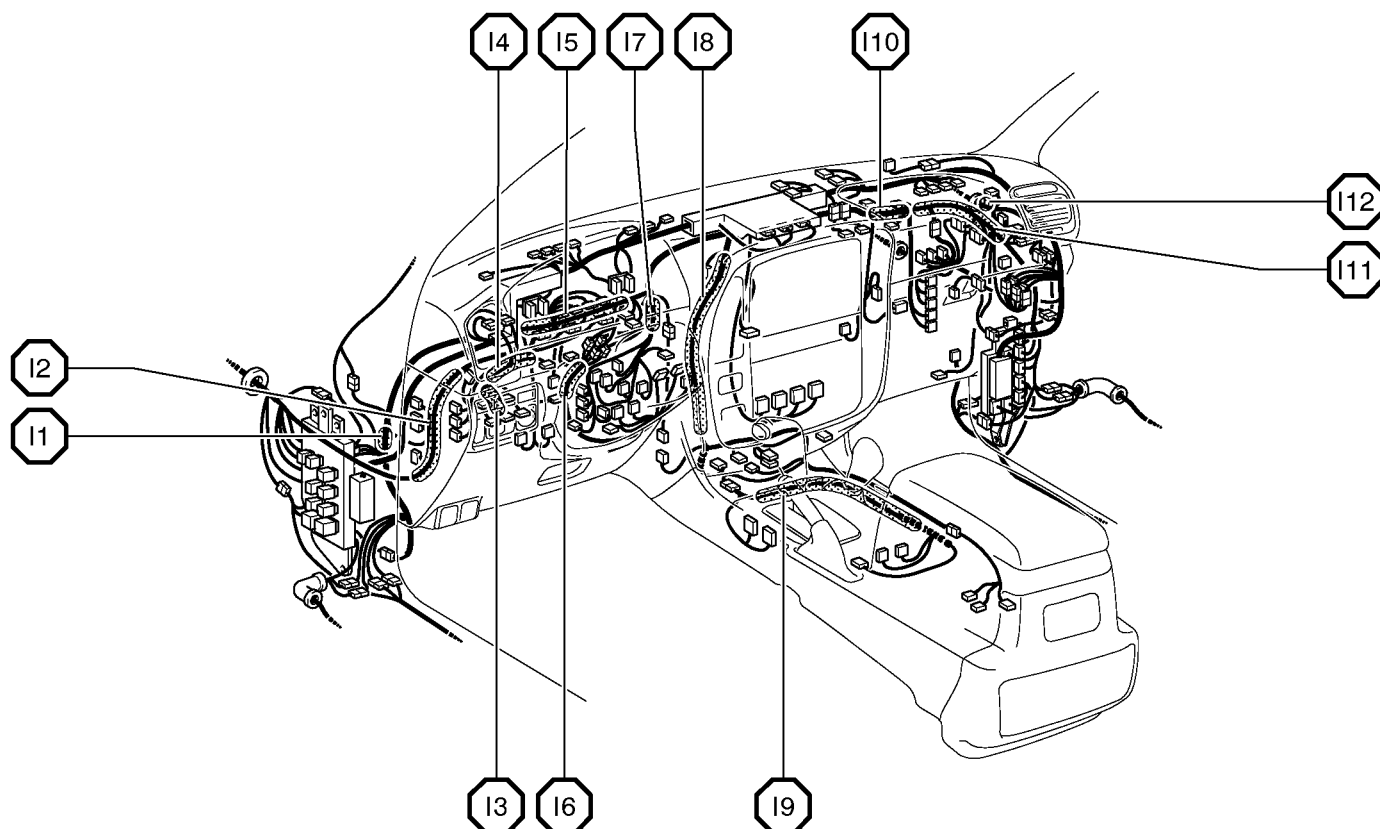

Connector Joining Wire Harness and Wire Harness

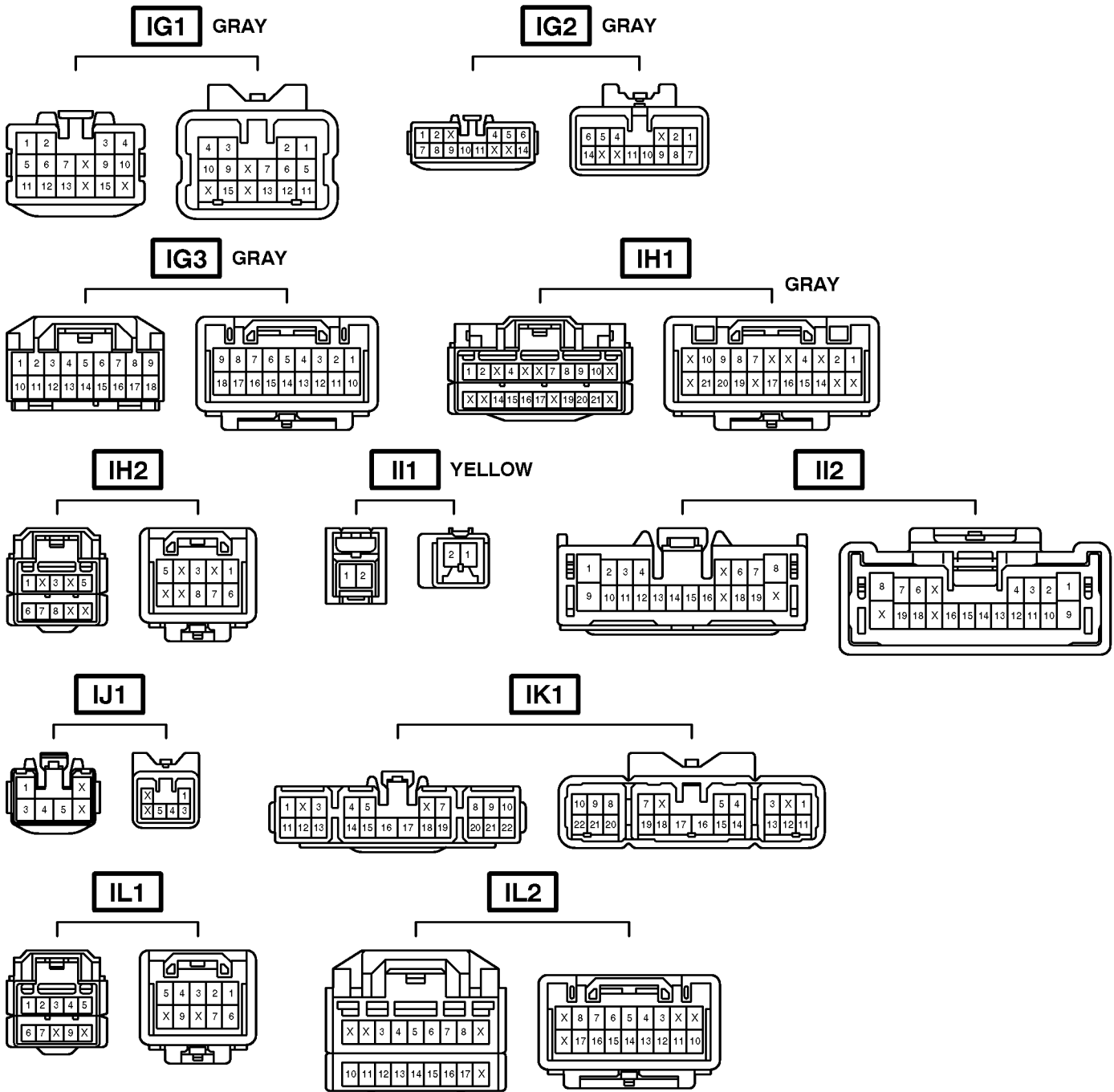

| Code | Joining Wire Harness and Wire Harness (Connector Location) |
|------|---|
| IG1 | Engine Room No.2 Wire and Dash Wire (Behind the Combination Meter) |
| IG2 | |
| IG3 | |
| IH1 | Instrument Panel Integration Wire and Column Wire (Near the Ignition SW) |
| IH2 | |
| II1 | Dash Wire and Column Wire (Near the Ignition SW) |
| II2 | Column Wire and Dash Wire (Near the Ignition SW) |
| IJ1 | Dash Wire and Detector Wire (Instrument Panel Center) |
| IK1 | Console Box Wire and Dash Wire (Left Side of Front Console) |
| IL1 | Instrument Panel Integration Wire and Computer Wire (Instrument Panel Center) |
| IL2 | |

G ELECTRICAL WIRING ROUTING

□ : Location of Connector Joining Wire Harness and Wire Harness

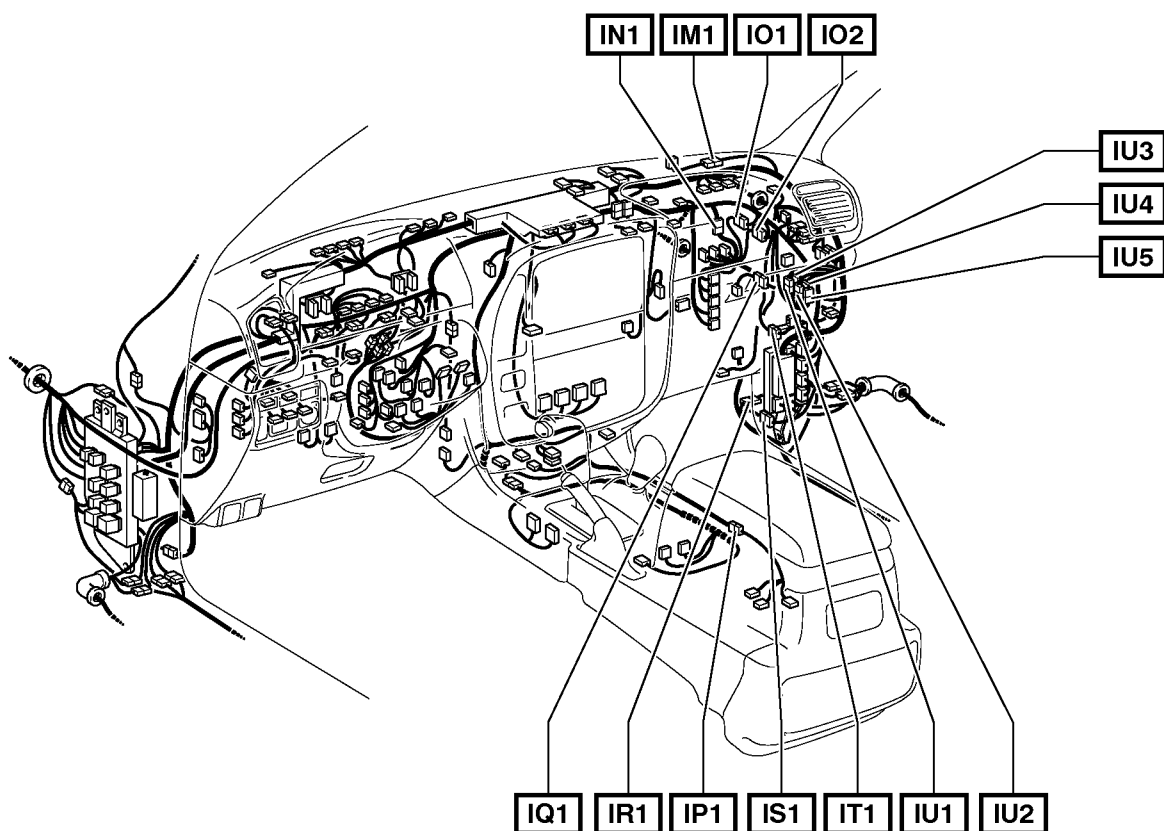

| Code | Joining Wire Harness and Wire Harness (Connector Location) |
|------|---|
| IM1 | Instrument Panel Integration Wire and Instrument Panel No.3 Wire (Right Side of Instrument Panel) |
| IN1 | Engine Wire and Dash Wire (Behind the Glove Box) |
| IO1 | |
| IO2 | |
| IP1 | Rear Console Box Wire and Dash Wire (Right Side of Rear Console) |
| IQ1 | Instrument Panel Integration Wire and Lamp Wire (Behind the Glove Box) |
| IR1 | Engine Room No.2 Wire and Floor No.2 Wire (Right Kick Panel) |
| IS1 | Dash Wire and Floor No.2 Wire (Right Kick Panel) |
| IT1 | Engine Room No.2 Wire and Dash Wire (Right Kick Panel) |
| IU1 | Instrument Panel Integration Wire and Dash Wire (Behind the Glove Box) |
| IU2 | |
| IU3 | |
| IU4 | |
| IU5 | |

Connector Joining Wire Harness and Wire Harness

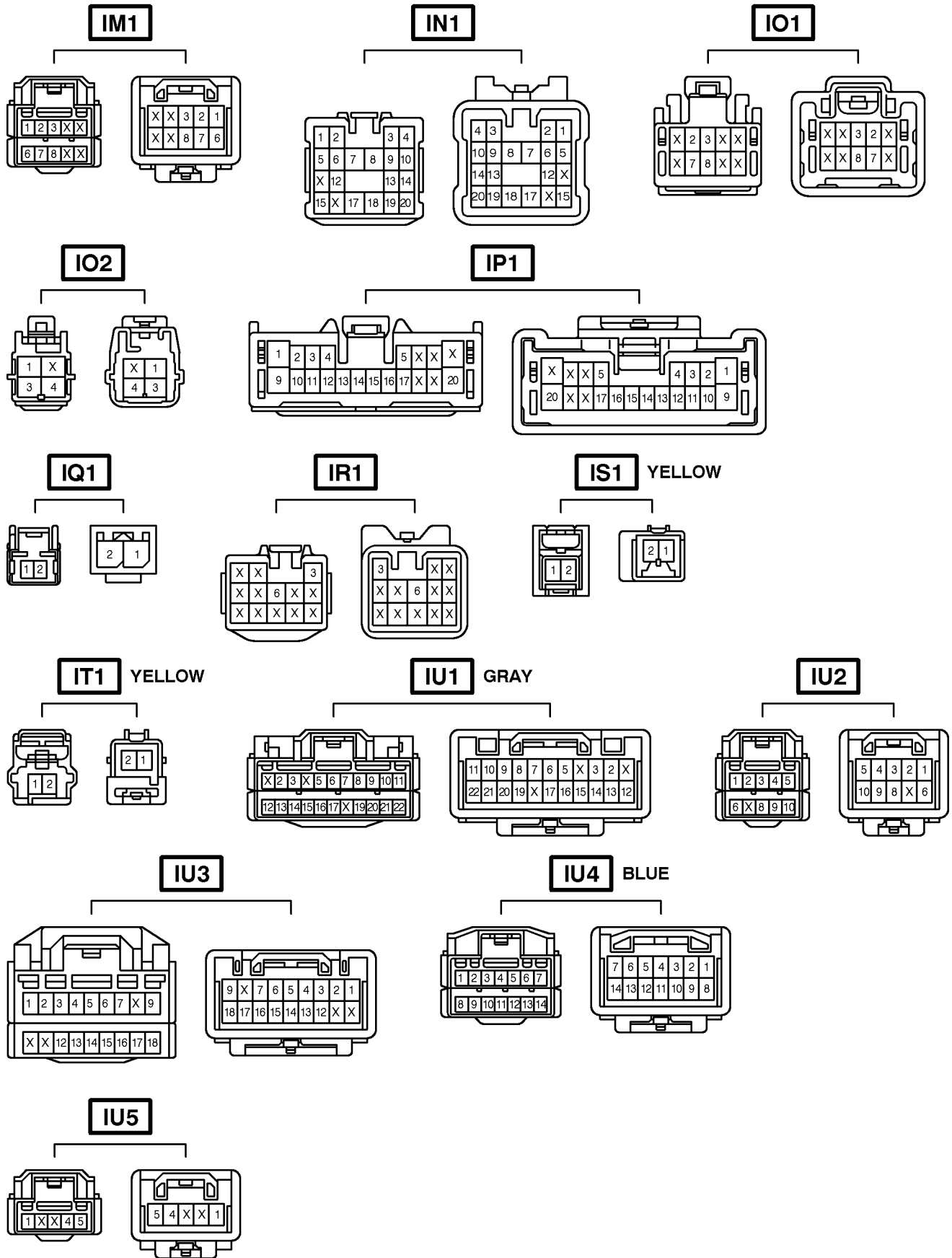

G ELECTRICAL WIRING ROUTING

□ : Location of Connector Joining Wire Harness and Wire Harness

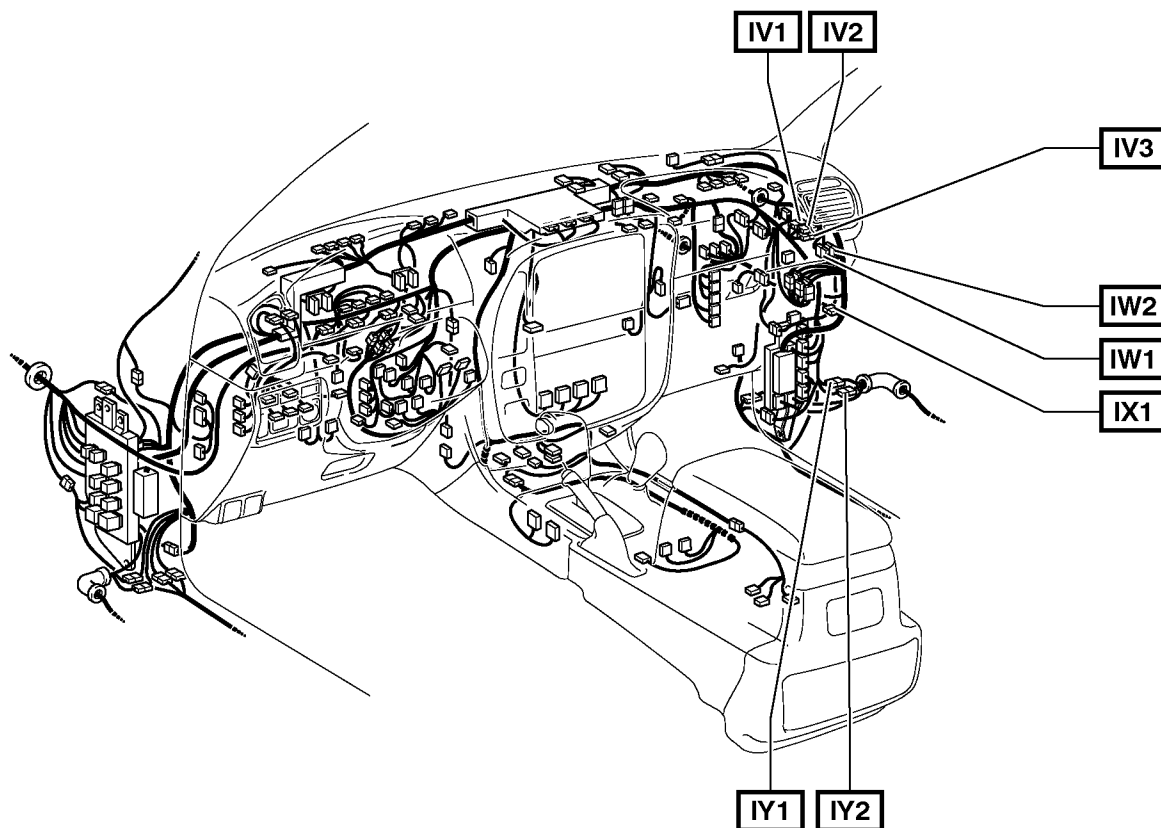

| Code | Joining Wire Harness and Wire Harness (Connector Location) |
|------|--|
| IV1 | Dash Wire and Floor No.2 Wire (Behind the Glove Box) |
| IV2 | |
| IV3 | |
| IW1 | Engine Room No.2 Wire and Dash Wire (Behind the Glove Box) |
| IW2 | |
| IX1 | Instrument Panel Integration Wire and Engine Wire (Behind the Glove Box) |
| IY1 | Front Door RH Wire and Dash Wire (Right Kick Panel) |
| IY2 | |

Connector Joining Wire Harness and Wire Harness

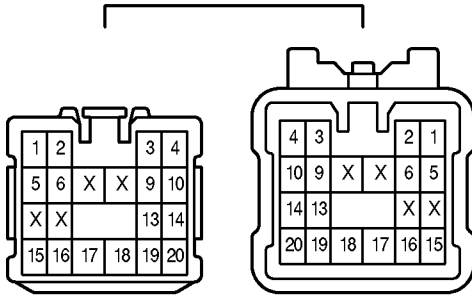
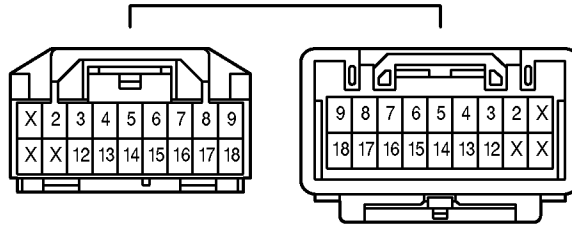
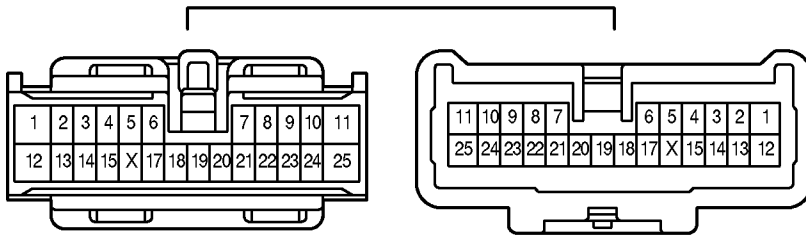
IV1**IV2****IV3****IW1**

DARK GRAY

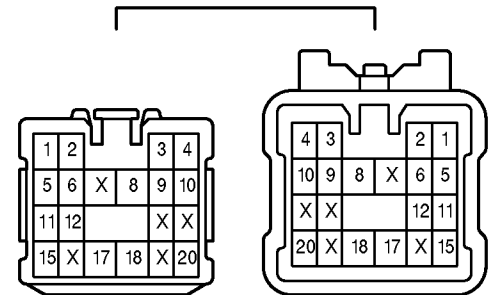
**IW2**

GRAY

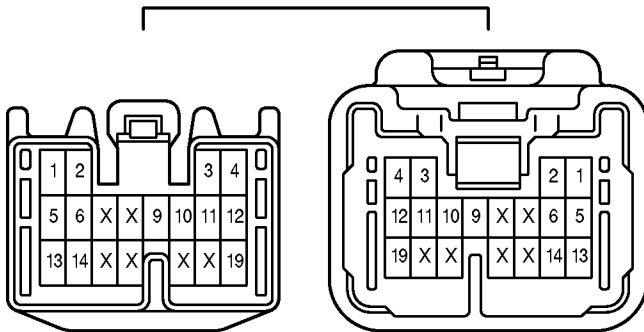
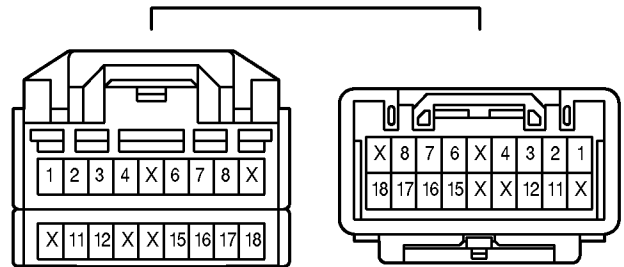
**IX1****IY1**

ORANGE

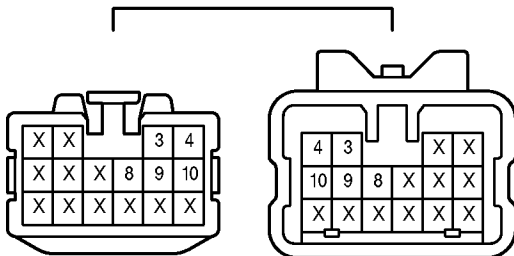
**IY2**

ORANGE

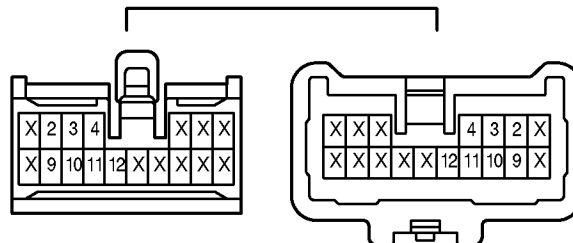

G ELECTRICAL WIRING ROUTING

□ : Location of Connector Joining Wire Harness and Wire Harness

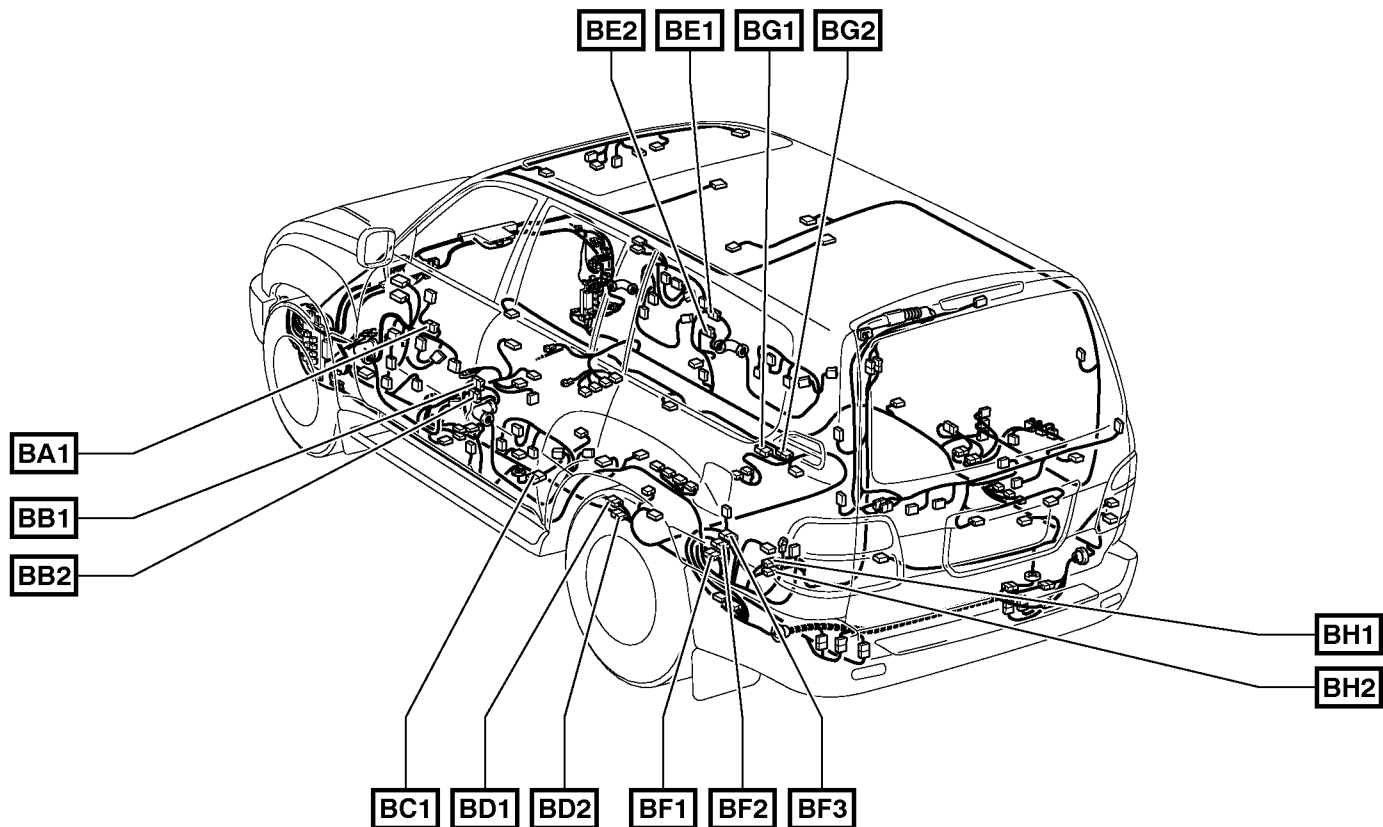

▽ : Location of Ground Points

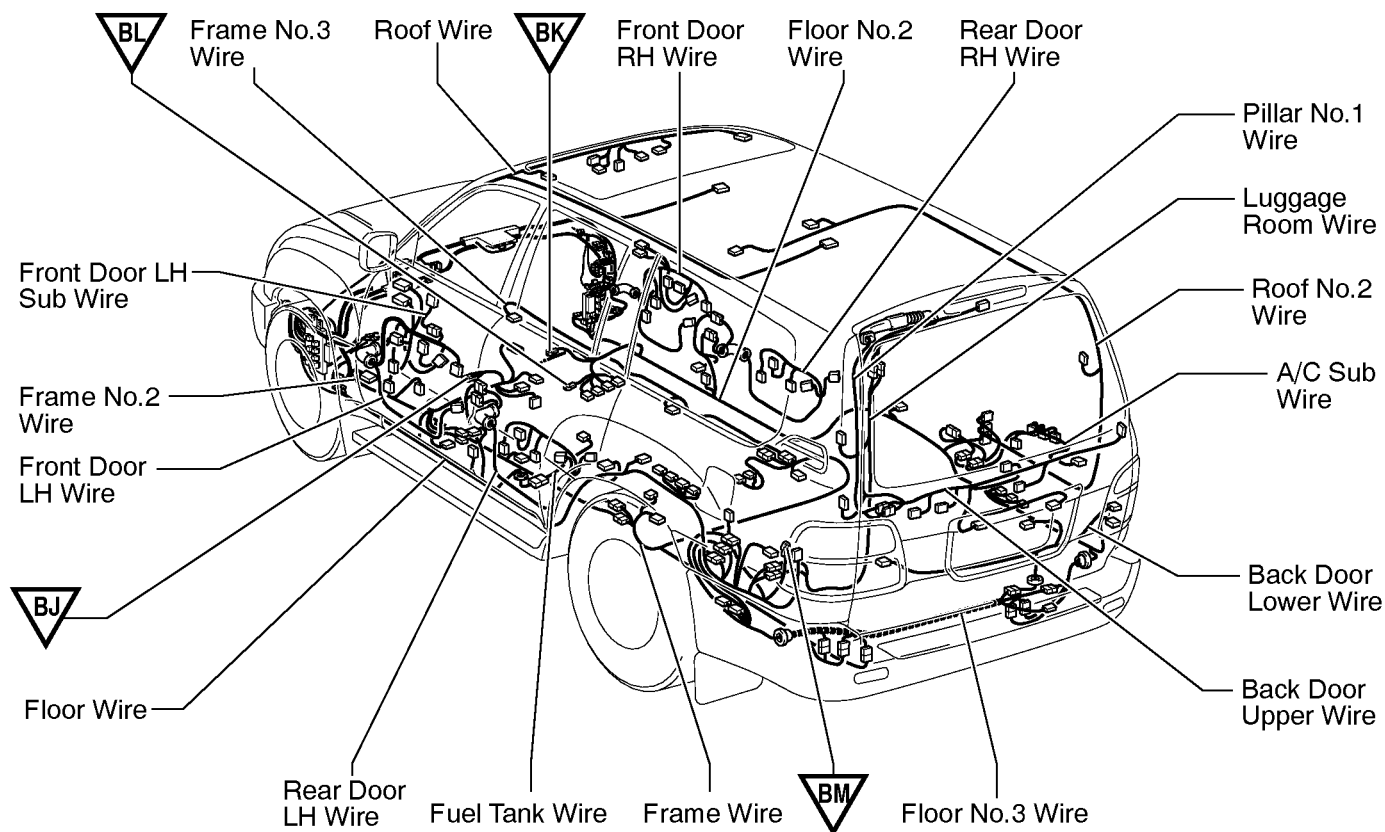

Connector Joining Wire Harness and Wire Harness

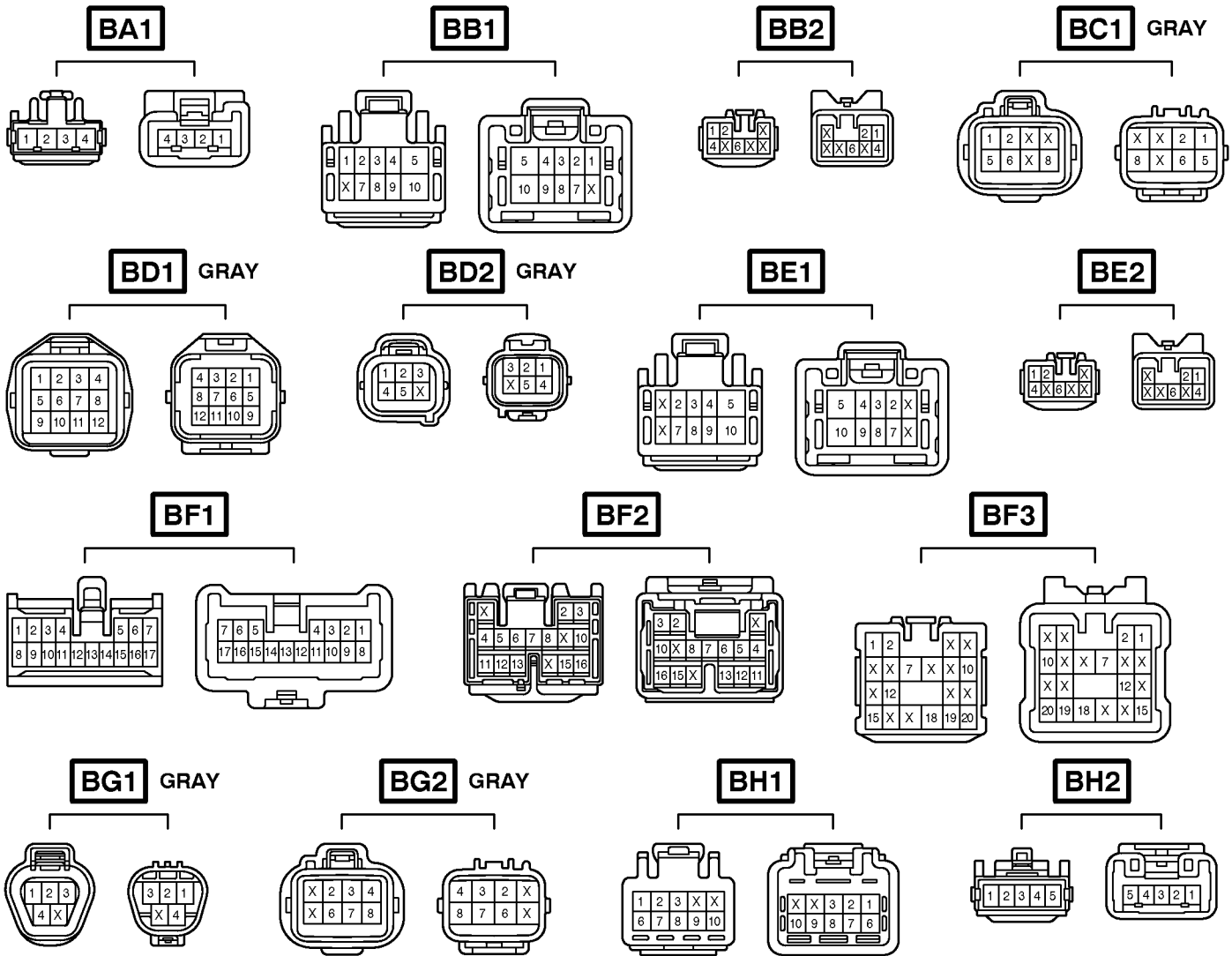

| Code | Joining Wire Harness and Wire Harness (Connector Location) |
|------|---|
| BA1 | Front Door LH Wire and Front Door LH Sub Wire (Front Door LH) |
| BB1 | Rear Door LH Wire and Floor Wire (Left Side of Center Pillar) |
| BB2 | |
| BC1 | Floor Wire and Fuel Tank Wire (Near the Fuel Tank) |
| BD1 | Frame No.2 Wire and Frame Wire (Near the Left Rear Suspension Support) |
| BD2 | |
| BE1 | Rear Door RH Wire and Floor No.2 Wire (Right Side of Center Pillar) |
| BE2 | |
| BF1 | |
| BF2 | Floor No.3 Wire and Floor Wire (Left Rear Side Quarter Panel) |
| BF3 | |
| BG1 | Frame No.3 Wire and Frame Wire (Near the Right Rear Suspension Support) |
| BG2 | |
| BH1 | Luggage Room Wire and Floor Wire (Left Rear Side Quarter Panel) |
| BH2 | |

G ELECTRICAL WIRING ROUTING

□ : Location of Connector Joining Wire Harness and Wire Harness

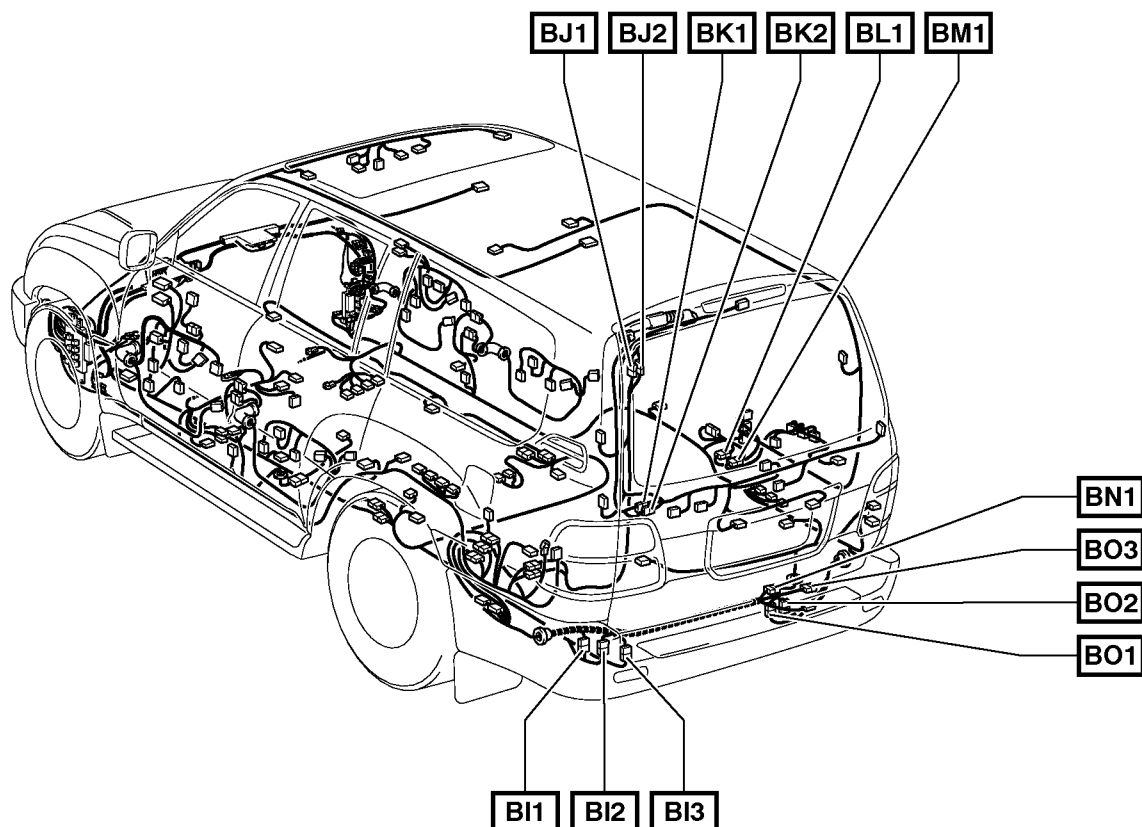

○ : Location of Splice Points

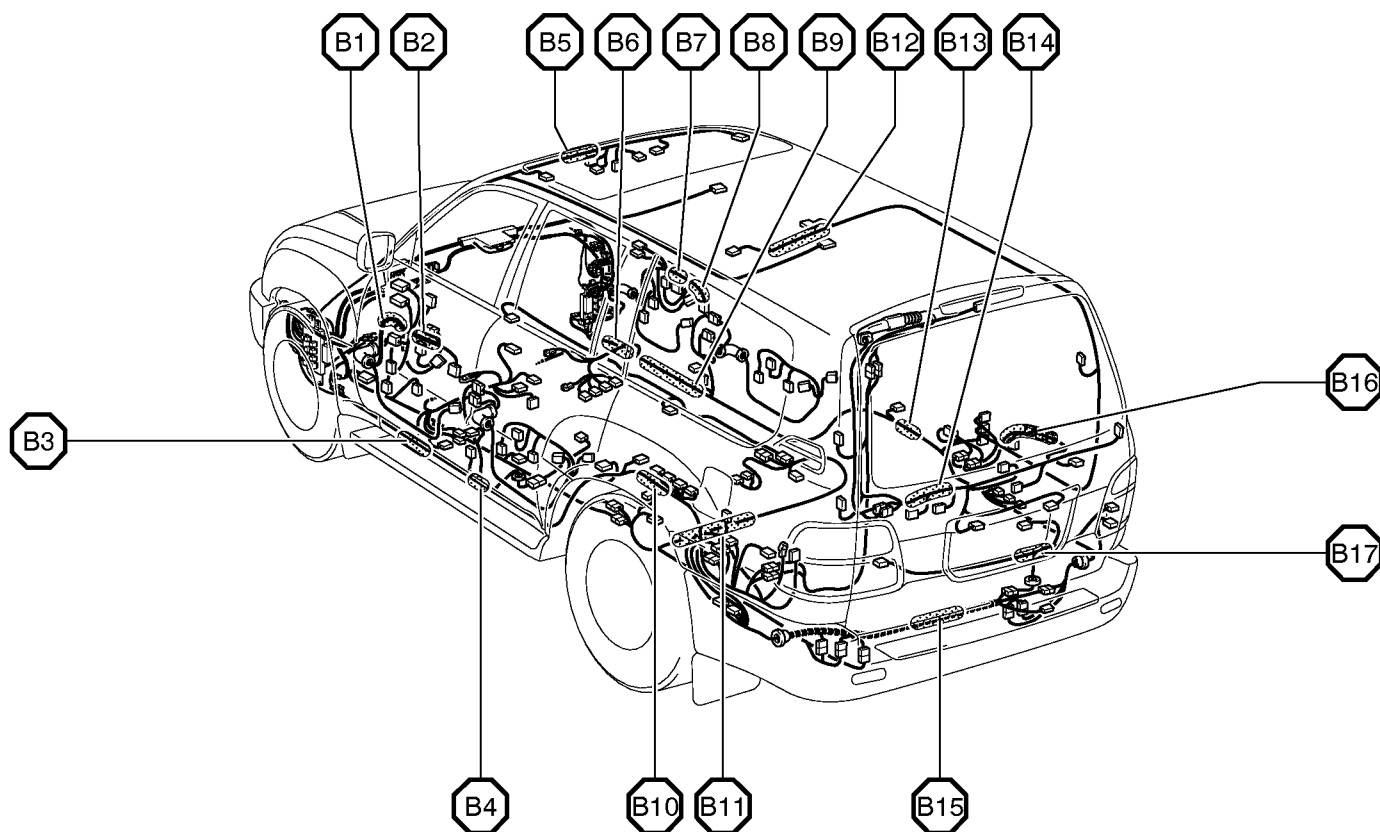

Connector Joining Wire Harness and Wire Harness

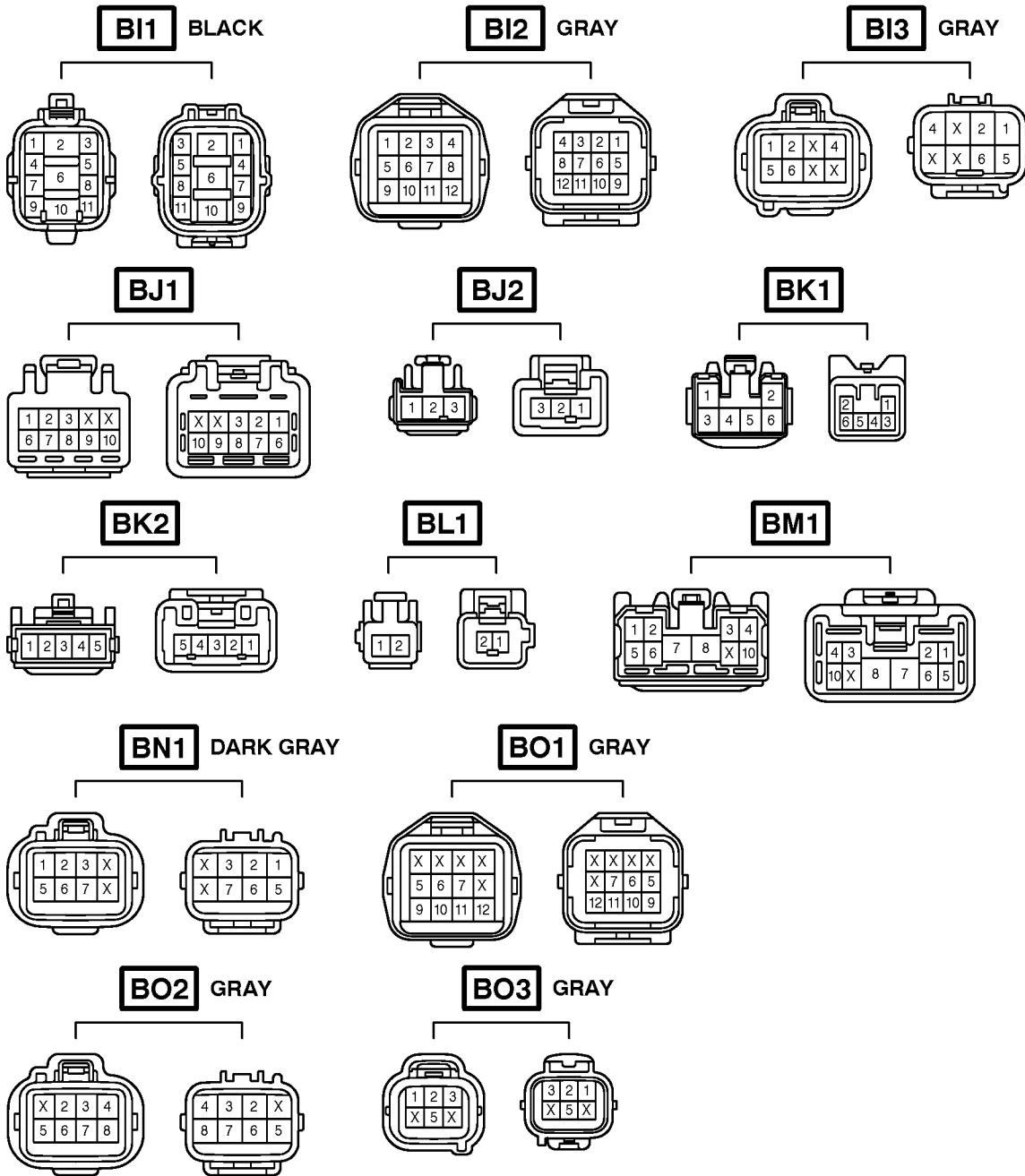

| Code | Joining Wire Harness and Wire Harness (Connector Location) |
|------|---|
| BI1 | Frame Wire and Floor No.3 Wire (Left Side of Rear Floor Crossmember) |
| BI2 | |
| BI3 | |
| BJ1 | Pillar No.1 Wire and Luggage Room Wire (Left Rear Side Roof Panel) |
| BJ2 | |
| BK1 | Pillar No.1 Wire and Back Door Upper Wire (Left Side of Back Door) |
| BK2 | |
| BL1 | Roof No.2 Wire and Floor No.2 Wire (Right Side Rear Quarter Panel) |
| BM1 | Floor No.2 Wire and A/C Sub Wire (Right Side Rear Quarter Panel) |
| BN1 | Back Door Lower Wire and Floor No.3 Wire (Right Side of Rear Floor Crossmember) |
| BO1 | Floor No.2 Wire and Floor No.3 Wire (Right Side of Rear Floor Crossmember) |
| BO2 | |
| BO3 | |

G ELECTRICAL WIRING ROUTING

□ : Location of Connector Joining Wire Harness and Wire Harness

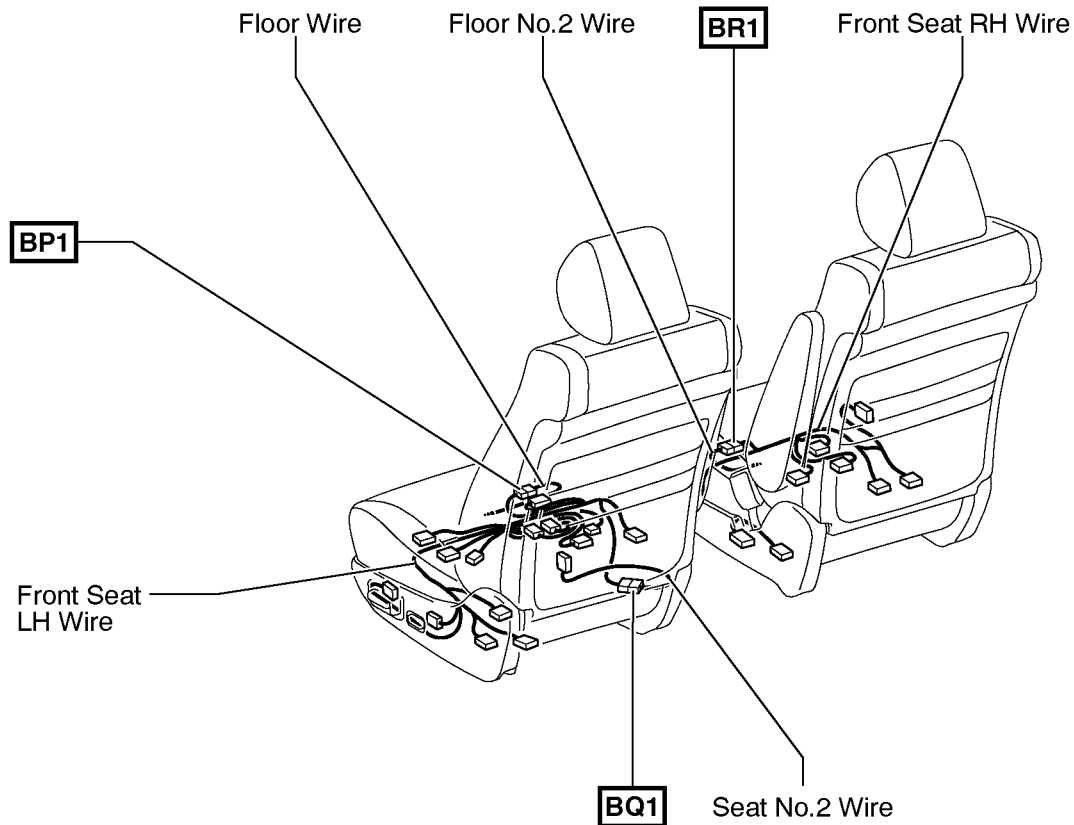

○ : Location of Splice Points

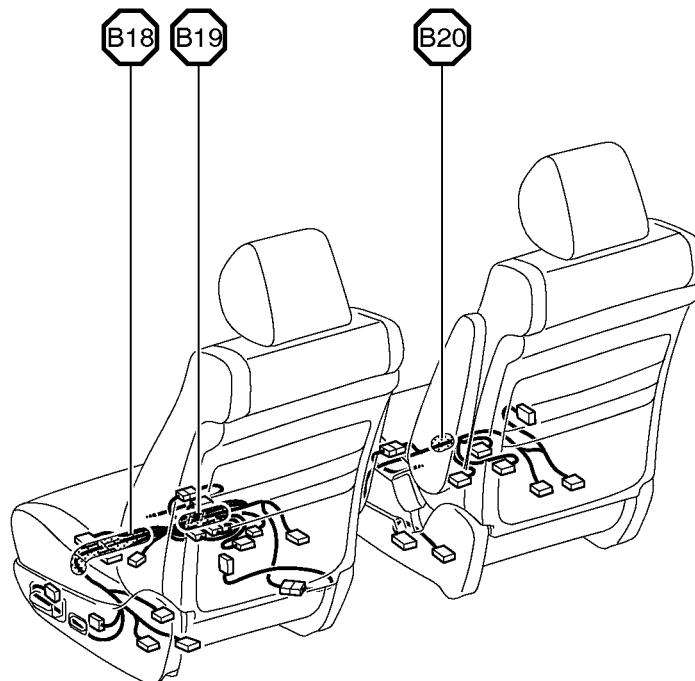

Connector Joining Wire Harness and Wire Harness

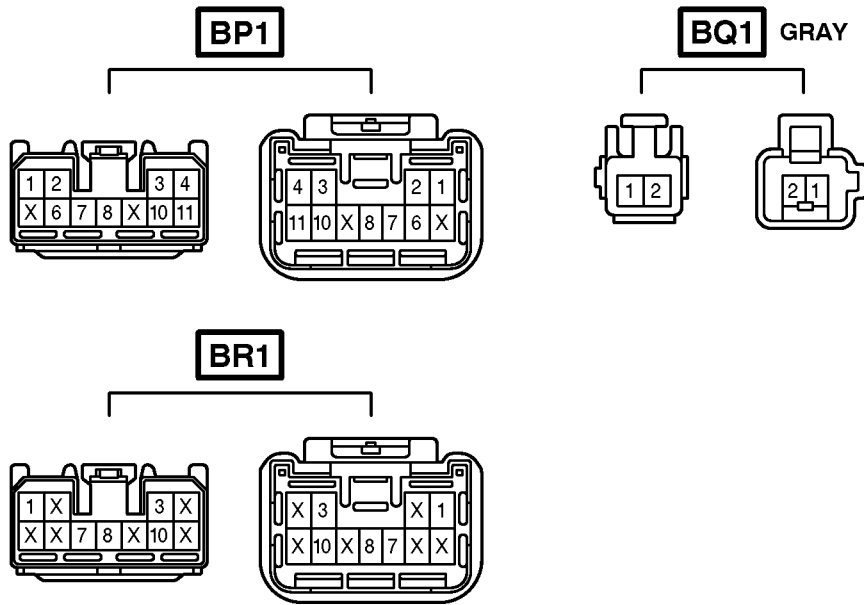

| Code | Joining Wire Harness and Wire Harness (Connector Location) |
|------|--|
| BP1 | Floor Wire and Front Seat LH Wire (Front Side Under the Driver's Seat) |
| BQ1 | Seat No.2 Wire and Front Seat LH Wire (Rear Side Under the Driver's Seat) |
| BR1 | Floor No.2 Wire and Front Seat RH Wire (Front Side Under the Front Passenger's Seat) |

NOTICE

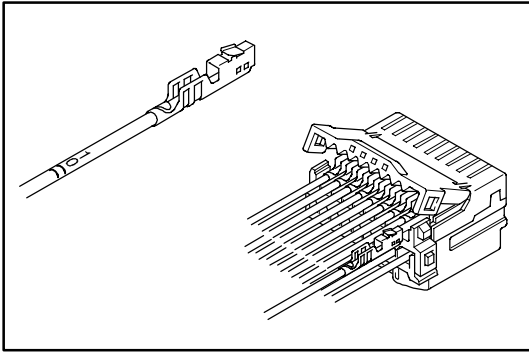

WIRE COLOR AND TERMINAL NUMBER

In some parts of the instrumental panel wiring harness, the same wire color (i.e. SB: Sky Blue) is used for all the wiring to a specific connector.

In order to identify the wiring, the terminal number is printed on the wiring.

Install the wiring to the connector position with the same terminal number.

Some early production Vehicles may not have these terminal numbers printed.

